



We bring water wherever you need!  
Upgrade your water & Life with WILO Pumps





## *Pumpen Intelligenz.*

Worldwide the Wilo is synonymous with the tradition of first class German engineering. Our pump systems for heating, refrigeration, air conditioning, water supply and sewage are used in commercial buildings, communal facilities, industry and, of course, in private homes.

In close cooperation with our customers, we have over the decades further developed our know-how from pumps and beyond to system competence.

This know-how is the basis for solutions geared towards meeting the special needs of our customers: that is what we call Pumpen Intelligenz.



*Pumpen Intelligenz.*

## Contents

Automatic Pressure Boosting	04-11
Multi-Purpose	12-16
Sea Water Application	17-19
Hot Water Circulation	20-23
Drainage	24-28
Sewage	29-30
Deep Well Application	31-33
Borehole Application	34-35
Wilo Pumps Korea products Ranges	36-38





*Pumpen Intelligenz.*



# Automatic Pressure Boosting Multi-Purpose

## Automatic Pressure Boosting

- By Flow Sensor (gravity)
- By Flow Sensor & Pressure Switch
- By Variable Frequency Device (Inverter)
- By Pressure Switch

## Multi-Purpose (Manual)

- For High Pressure
- For Big Flow
- For various machinery  
(Circulation, Pressure Boosting)
- For Portable application
- For Filtering
- For Whirlpool Bath



# AUTOMATIC PRESSURE BOOSTING



## BY FLOW SENSOR (GRAVITY)



PB-088EA

### Centrifugal Homebooster

PB-088EA/ PB-200EA/ PB-201EA/ PB-400EA

**Feature:**  
 Flow Sensor  
 Liquid Temp: Up to 80 °C  
 Centrifugal Impeller, low noise  
 Constant working pressure  
 CE certificate

**Application:**  
 Roof tank to tap water transfer, Pressure boosting in household

#### Specification

Model	Power Source		Power (kW)		Head (m)			Rated Flow rate		Max. Flow rate		Weight (kg)	
	Voltage(V)	Frequency(Hz)	Input(p1)	Output(p2)	Total Head	Suction Head	Discharge Head	ℓ/min	At Ht	ℓ/min	m <sup>3</sup> /hr	Net	Gross
PB-088EA	220	50	0.14	0.07	8	0	8	35	0.5	35	2.1	3.5	4.0
PB-200EA	220	50	0.34	0.20	15	0	15	50	0.5	50	3.0	7.5	8.0
PB-201EA	220	50	0.34	0.20	15	0	15	65	0.5	65	3.9	7.5	8.0
PB-400EA	220	50	0.55	0.40	20	0	20	75	0.5	75	4.5	12.5	13.0



PB-S125EA

### Rust Proof Centrifugal Homebooster

PB-S125EA

**Feature:**  
 Perfect rustproof by Engineering plastic hydraulics  
 Low noise level (below 50dB)  
 Accurate automatic operation  
 High efficiency  
 Compact and light  
 Liquid Temp: Up to 80 °C

**Application:**  
 Roof tank to tap water transfer, Pressure boosting in household

#### Specification

Model	Power Source		Power (kW)		Head (m)			Rated Flow rate		Max. Flow rate		Weight (kg)	
	Voltage(V)	Frequency(Hz)	Input(p1)	Output(p2)	Total Head	Suction Head	Discharge Head	ℓ/min	At Ht	ℓ/min	m <sup>3</sup> /hr	Net	Gross
PB-S125EA	220	50	0.23	0.13	11	0	11	42	0.5	42	2.5	4.5	5.0

#### Performance Curve

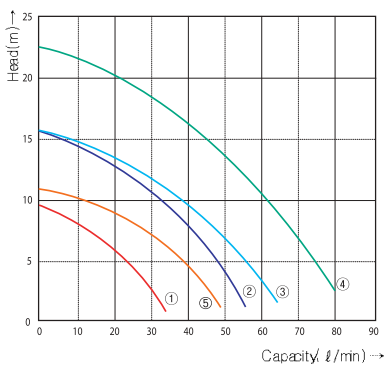

① PB-088EA ② PB-200EA  
 ③ PB-201EA ④ PB-400EA ⑤ PB-S125EA

#### Outline Drawing

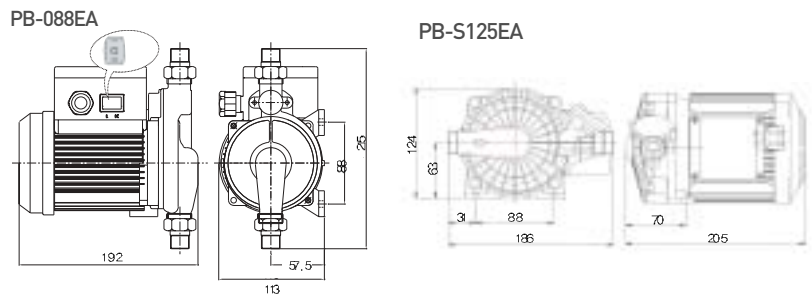

#### PB-200EA/201EA/400EA

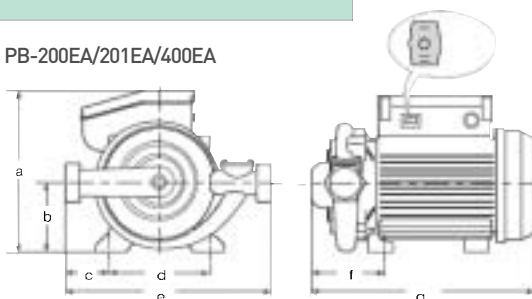

Unit=mm

Model	a	b	c	d	e	f	g
PB-200EA	176	74	45	91	220	85	235
PB-201EA	176	74	57	91	240	95	237
PB-400EA	207	95	63	124	270	105	275

# AUTOMATIC PRESSURE BOOSTING



BY FLOW SENSOR & PRESSURE SWITCH



PB-250SEA

## Centrifugal Homebooster with pressure tank

PB-250SEA/ 401SEA

**Feature:**  
 Flow Sensor & Pressure Switch  
 Liquid Temp: Up to 60 °C  
 3m suction is possible with a foot valve

**Application:**  
 Pressure boosting for water supply application in household

### Specification

Model	Power Source		Power (kW)		Head (m)			Rated Flow rate		Max. Flow rate		Weight (kg)	
	Voltage(V)	Frequency(Hz)	Input(p1)	Output(p2)	Total Head	Suction Head	Discharge Head	ℓ/min	At Ht	ℓ/min	m <sup>3</sup> /hr	Net	Gross
PB-250SEA	220	50	0.41	0.20	11	3	8	35	12.0	65	3.9	9.5	10.0
PB-401SEA	220	50	0.50	0.40	14	3	11	45	3.0	65	3.9	14.5	15.0



PWS-200SEA

## Self-Priming Peripheral pump with pressure tank

PWS-200SEA

**Feature:**  
 Flow Sensor & Pressure Switch  
 Constant Pressure  
 Liquid Temp: Up to 60

**Application:**  
 Pressure boosting,

### Specification

Model	Power Source		Power (kW)		Head (m)			Rated Flow rate		Max. Flow rate		Weight (kg)	
	Voltage(V)	Frequency(Hz)	Input(p1)	Output(p2)	Total Head	Suction Head	Discharge Head	ℓ/min	At Ht	ℓ/min	m <sup>3</sup> /hr	Net	Gross
PWS-200SEA	220	50	0.40	0.20	14	3	11	18	12.0	30	1.8	12.0	13.0

### Performance Curve

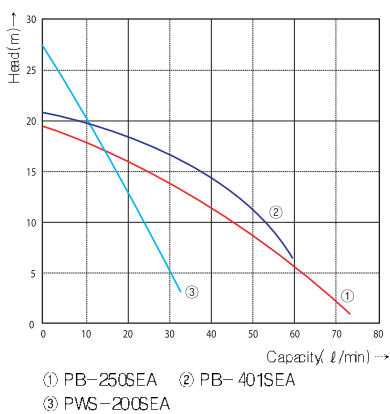

### Outline Drawing

PB-250SEA

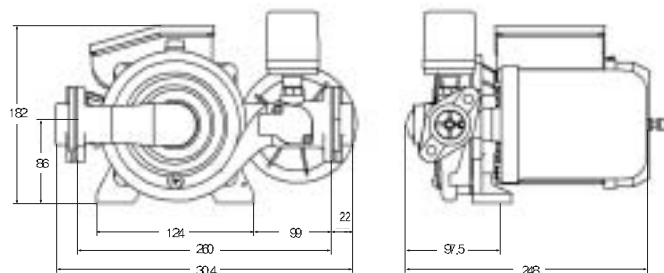

PB-401SEA

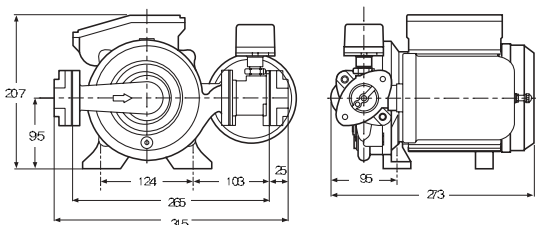

PWS-200SEA

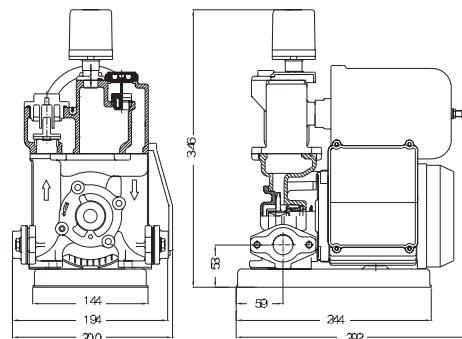





MHIKE Series

### Horizontal Multistage Pump with Inverter

MHIKE Series

#### Feature:

Liquid Temp: up to 80 °C/ Control by integrated-Inverter / Automatic / Manual Operation  
Adjustable working pressure / Various Protection - (Voltage, Current, Dry-Running, Heat, Pressure, Sensor, Power, Locked impeller etc)  
Easy Operation / Maintenance / Stainless Steel Hydraulics / Low noise, low vibration  
Flexible Union Piping for various installation directions

#### Application:

Various water supply application, sprinklers

#### Specification

Model	Power Source		Power (kW)		Head (m)			Rated Flow rate		Max. Flow rate		Weight (kg)	
	Voltage(V)	Frequency(Hz)	Input(p1)	Output(p2)	Total Head	Suction Head	Discharge Head	ℓ/min	At Ht	ℓ/min	m <sup>3</sup> /hr	Net	Gross
MHIKE 203A	220/230	50/60	0.92	0.75	47	0	47	33	36.0	100	6.0	18.0	19.0
MHIKE 205A	220/230	50/60	1.55	1.10	80	0	80	33	60.0	100	6.0	18.0	19.0
MHIKE 402A	220/230	50/60	0.92	0.75	30	0	30	67	22.0	150	9.0	19.0	20.0
MHIKE 403A	220/230	50/60	1.55	1.10	46	0	46	66	35.0	150	9.0	21.0	22.0
MHIKE 404A	220/230	50/60	2.17	1.50	62	0	62	67	42.0	150	9.0	23.0	24.0
MHIKE 405A	220/230	50/60	2.38	1.85	80	0	80	67	60.0	150	9.0	22.0	23.0
MHIKE 802A	220/230	50/60	2.17	1.50	30	0	30	133	22.0	267	16.0	24.0	25.0
MHIKE 803A	220/230	50/60	2.38	1.85	48	0	48	133	35.0	267	16.0	24.0	25.0



PUI-S991A

### Self Priming Centrifugal pump with Inverter

PUI-S991A

#### Feature:

Self priming (MAX:6m) / Rust-proof (Material of Construction: Engineering Plastic, Stainless Steel)  
Control by integrated-Inverter (Same as MHIKE series)  
Various Protection and Functions (inc. Monitoring on self-priming)  
Liquid Temp: up to 80 °C/ Flexible Union Piping for various installation directions

#### Application:

Various water supply application for potable, domestic water (without flooded suction)

#### Specification

Model	Power Source		Power (kW)		Head (m)			Rated Flow rate		Max. Flow rate		Weight (kg)	
	Voltage(V)	Frequency(Hz)	Input(p1)	Output(p2)	Total Head	Suction Head	Discharge Head	ℓ/min	At Ht	ℓ/min	m <sup>3</sup> /hr	Net	Gross
PUI-S991A	220/230	50/60	1.80	1.50	31	6	25	300	0.0	300	18.0	23.0	24.0



MHIKE-D Series

### Dual Horizontal Multistage pumps with individual inverters

MHIKE-D Series

#### Feature:

Low noise Mode / Power-saving Mode / Warm-up Operation Mode  
Alternative Operation Mode / Automatic Back-up Mode when in trouble / Easy Maintenance  
Stainless Steel Material for all hydraulics (inc. Pipework and Valves)  
Separate power supply for better safety  
Easy installation, maintenance

#### Application:

Various water supply application in medium sized houses, buildings

#### Specification

Model	Power Source		Power (Kw)		Head (m)			Rated Flow rate		Max. Flow rate		Weight (kg)	
	Voltage(V)	Frequency(Hz)	Input(p1)	Output(p2)	Total Head	Suction Head	Discharge Head	ℓ/min	At Ht	ℓ/min	m <sup>3</sup> /hr	Net	Gross
MHIKE D404A	220/230	50/60	2.17X2	1.5X2	62	0	62	134	45.0	334	20.0	51.0	55.0
MHIKE D405A	220/230	50/60	2.38X2	1.85X2	80	0	80	134	60.0	334	20.0	64.0	68.0
MHIKE D802A	220/230	50/60	2.17X2	1.5X2	30	0	30	268	22.0	600	36.0	54.0	58.0
MHIKE D803A	220/230	50/60	2.38X2	1.85X2	48	0	48	268	35.0	600	36.0	67.0	71.0



### Performance Curve

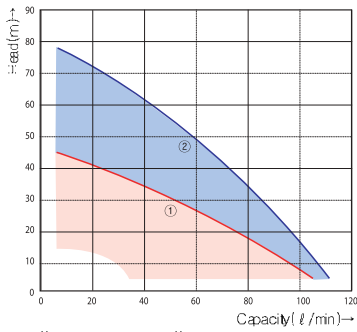

① MHIKE 203A    ② MHIKE 205A

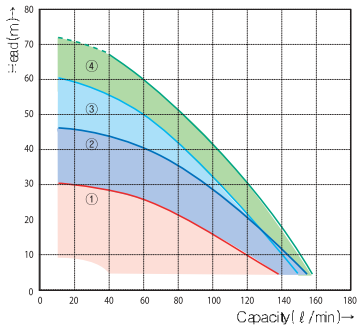

① MHIKE 402A    ② MHIKE 403A  
③ MHIKE 404A    ④ MHIKE 405A

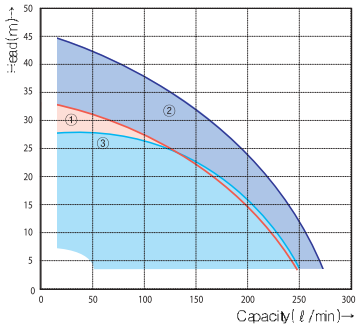

① MHIKE 802A    ② MHIKE 803A    ③ PUI-S991A

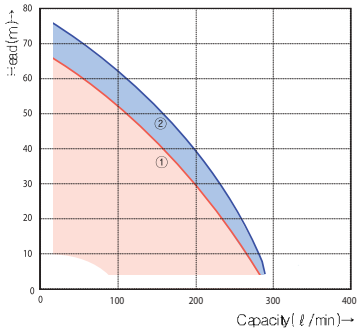

① MHIKE D404A    ② MHIKE D405A

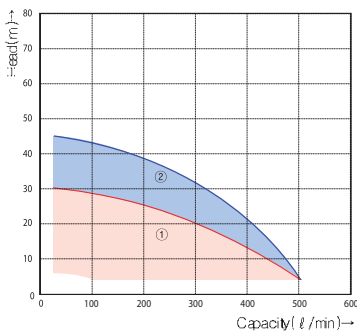

① MHIKE D802A    ② MHIKE D803A

### Outline Drawing

#### MHIKE Series

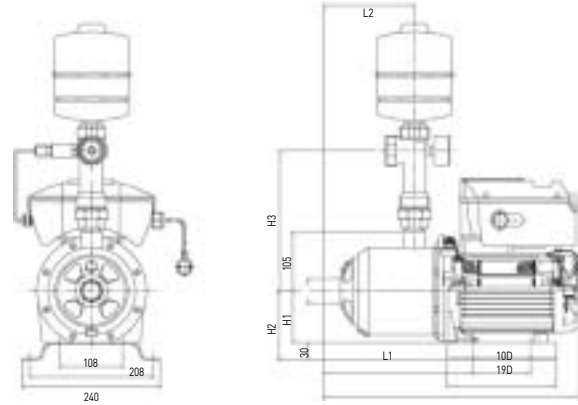

Model	H	H1	H2	H3	L	L1	L2	Model	H	H1	H2	H3	L	L1	L2
MHIKE 203A	610	90	120	350	385	185	109.5	MHIKE 404A	610	90	120	350	425	225	157.5
MHIKE 205A	610	90	120	350	430	235	157.5	MHIKE 405A	610	90	120	350	425	225	157.5
MHIKE 402A	610	90	120	350	385	185	109.5	MHIKE 802A	630	90	120	365	390	190	121.5
MHIKE 403A	610	90	120	350	385	185	109.5	MHIKE 803A	630	90	120	365	390	190	121.5

### Outline Drawing

#### MHIKE-D

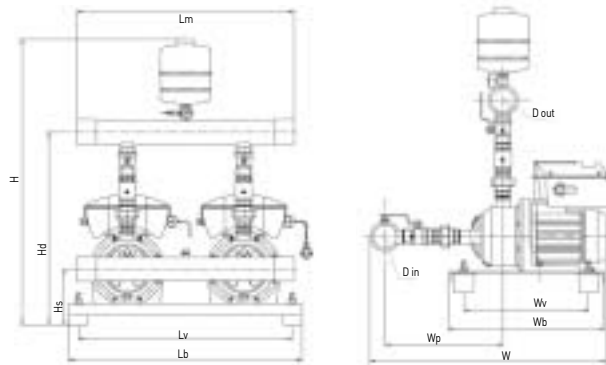

Model	H	Hs	Hd	Lm	Lv	Lb	W	Wp	Wv	Wb	D in	D out
MHIKE-D404A	870	140	530	560	550	600	655	360	320	400	50A	50A
MHIKE-D405A	870	140	530	560	550	600	655	360	320	400	50A	50A
MHIKE-D802A	900	140	560	560	550	600	725	380	320	400	65A	65A
MHIKE-D803A	900	140	560	560	550	600	725	380	320	400	65A	65S

#### PUI-S991A

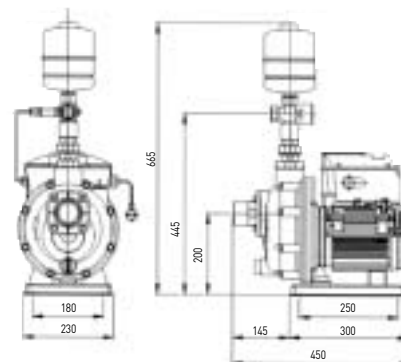



PW-122EA



PW-404EA



PW-1500EA



PU-460EA

### Pressure Boosting Pumps with pressure tanks

PW-082EA/100EA/111EA/115EA/122EA/150EA/151EA/175EA/250EA/251EA/ PW-252EA/404EA/1500EA/PU-460EA

#### Feature:

Self-Priming

Automatic Operation by Pressure Switch

#### Application:

Well, Small to medium-sized buildings

#### Specification

Model	Power Source		Power (kW)		Head (m)			Rated Flow rate		Max. Flow rate		Weight (kg)	
	Voltage(V)	Frequency(Hz)	Input(p1)	Output(p2)	Total Head	Suction Head	Discharge Head	ℓ/min	At Ht	ℓ/min	m <sup>3</sup> /hr	Net	Gross
PW-082EA	220	50	0.24	0.08	15	8	7	15	9.0	20	1.2	11.0	12.0
PW-100EA	220	50	0.31	0.10	18	8	10	19	9.0	25	1.5	14.5	15.0
PW-111EA	220	50	0.31	0.12	18	8	10	19	9.0	25	1.5	15.0	16.0
PW-115EA	220	50	0.31	0.12	18	8	10	19	9.0	25	1.5	15.0	16.0
PW-122EA	220	50	0.32	0.13	18	8	10	22	9.0	25	1.5	13.0	14.0
PW-150EA	220	50	0.35	0.15	19	8	11	23	9.0	25	1.5	20.0	21.0
PW-151EA	220	50	0.35	0.15	19	8	11	23	9.0	25	1.5	19.0	20.0
PW-175EA	220	50	0.35	0.13	19	8	11	30	1.0	30	1.8	8.0	9.0
PW-250EA	220	50	0.60	0.25	24	8	16	35	9.0	40	2.4	28.0	30.0
PW-251EA	220	50	0.60	0.25	24	8	16	35	9.0	40	2.4	29.0	30.0
PW-252EA	220	50	0.60	0.25	24	8	16	34	9.0	40	2.4	22.0	23.6
PW-404EA	220	50	1.00	0.40	33	8	25	32	9.0	55	3.3	40.0	45.0
PW-1500EA	220	50	1.80	1.50	43	8	35	40	32.0	55	3.3	47.0	50.0
PU-460EA	220	50	1.00	0.40	11	5	6	110	12.0	150	9.0	37.5	39.0

### Performance Curve

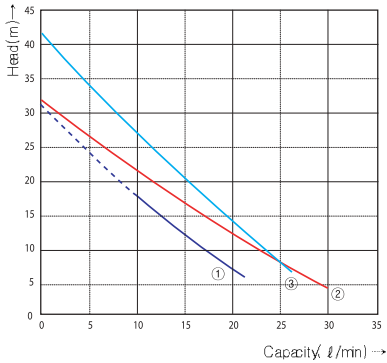

- ① PW-082EA    ② PW-100EA
- ③ PW-111EA

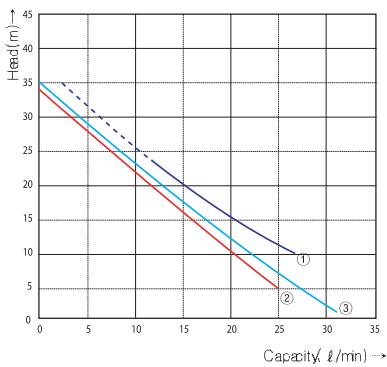

- ① PW-115EA    ② PW-122EA
- ③ PW-175EA

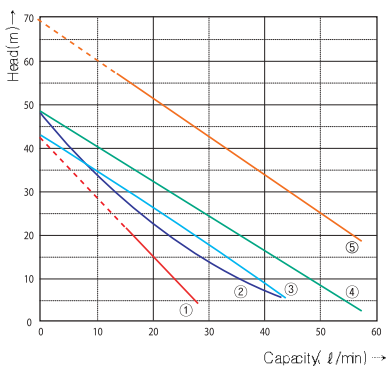

- ① PW-150,151EA    ② PW-250,251EA
- ③ PW-252EA    ④ PW-404EA
- ⑤ PW-1500EA

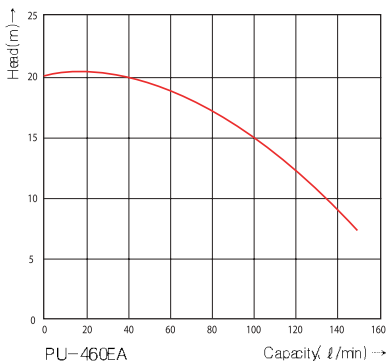

PU-460EA

### Outline Drawing

PW-082EA / 100EA

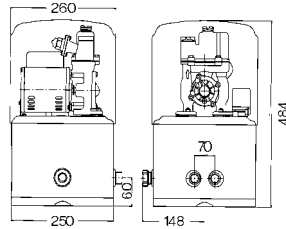

PW-111EA / 115EA

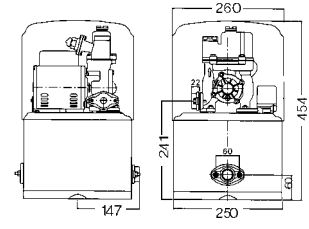

PW-122EA

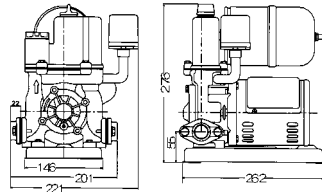

PW-150EA

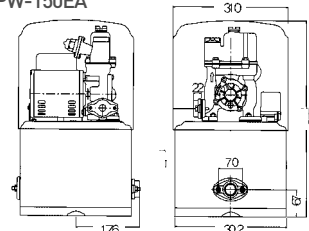

PW-151EA

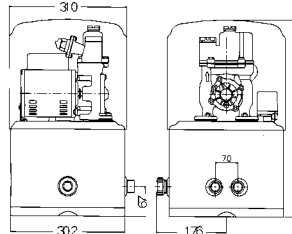

PW-175EA

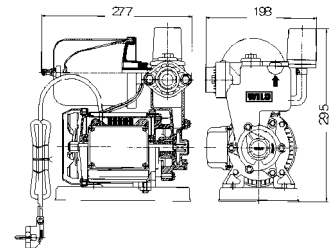

PW-250EA

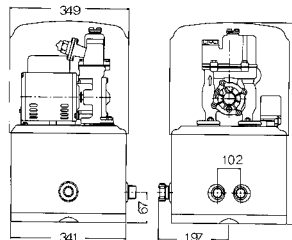

PW-251EA

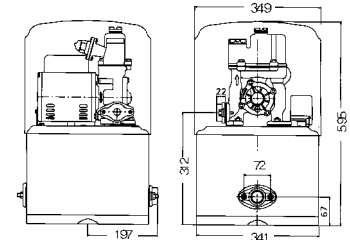

PW-252EA

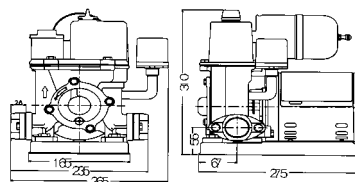

PW-404EA

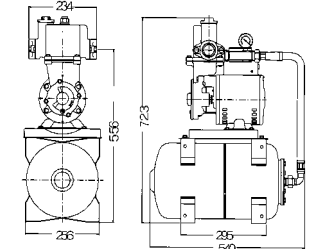

PW-1500EA

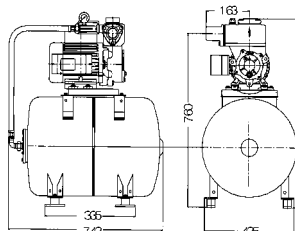

PU-460EA

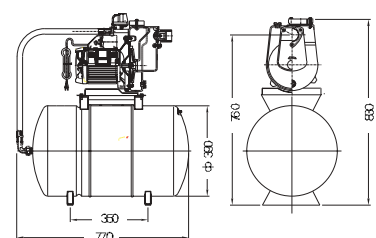





PW-121E

PW-401E

### Pressure Boosting Pumps without pressure tanks

PW-081E/121E/175E/251E/375E/401E/1500E/1500G

#### Feature:

Easy Maintenance  
Self Priming

#### Application:

Houses, General Water supply by high pressure

#### Specification

Model	Power Source		Power (kW)		Head (m)			Rated Flow rate		Max. Flow rate		Weight (kg)	
	Voltage(V)	Frequency(Hz)	Input(p1)	Output(p2)	Total Head	Suction Head	Discharge Head	ℓ/min	At Ht	ℓ/min	m <sup>3</sup> /hr	Net	Gross
PW-081E	220	50	0.24	0.08	18	8	10	15	9.0	20	1.2	10.0	10.6
PW-121E	220	50	0.32	0.13	24	8	16	22	9.0	25	1.5	10.0	12.0
PW-175E	220	50	0.35	0.13	26	8	18	30	1.0	30	1.8	6.2	7.0
PW-251E	220	50	0.60	0.25	32	8	24	34	9.0	40	2.4	18.8	19.5
PW-401E	220	50	1.00	0.40	36	8	28	45	9.0	60	3.6	21.0	22.0
PW-1500E	220	50	1.80	1.50	58	8	50	40	42.0	60	3.6	35.0	36.0
PW-1500G	3φ220/280	50	1.80	1.50	58	8	50	40	42.0	60	3.6	35.0	36.0

#### Outline Drawing

PW-081E

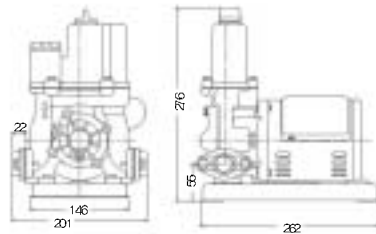

PW-121E

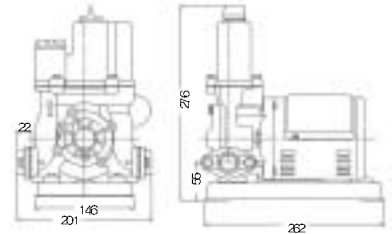

PW-175E

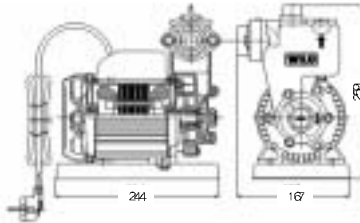

PW-251E

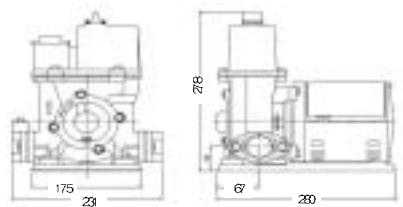

PW-401E

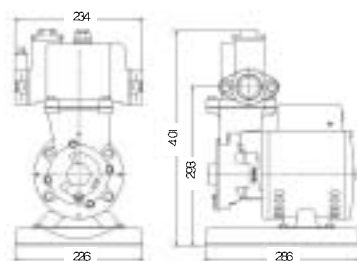

PW-1500E/1500G

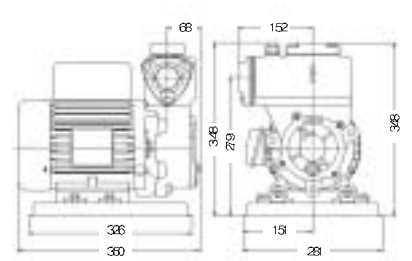

#### Performance Curve

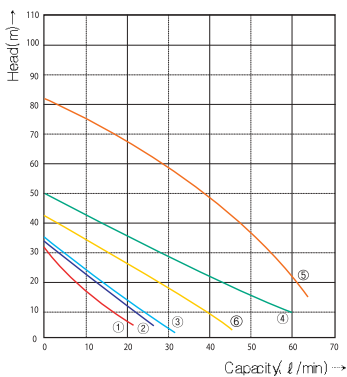

- ① PW-081E    ② PW-121E    ③ PW-175E
- ④ PW-401E    ⑤ PW-1500E/G    ⑥ PW-251E



### Centrifugal Pumps for agricultural & industrial use (Big Flow)

PU-251E/400E/461E/462E/1500E/1500G



PU-400E



PU-461/462E



PU-1500E

**Feature:**  
 Self-priming  
 TEFC motor  
 Big flow applications

**Application:**  
 Agricultural use, industrial use

### Specification

Model	Power Source		Power (kW)		Head (m)			Rated Flow rate		Max. Flow rate		Weight (kg)	
	Voltage(V)	Frequency(Hz)	Input(p1)	Output(p2)	Total Head	Suction Head	Discharge Head	ℓ/min	At Ht	ℓ/min	m <sup>3</sup> /hr	Net	Gross
PU-251E	220	50	0.60	0.25	9	6	3	110	7.0	140	8.4	15.0	16.0
PU-400E	220	50	0.60	0.40	9	6	3	110	7.0	145	8.7	16.0	16.5
PU-461E	220	50	0.90	0.50	14	6	8	200	8.0	230	13.8	30.0	30.0
PU-462E	220	50	0.90	0.50	14	6	8	200	8.0	230	13.8	30.0	30.0
PU-1500E	220	50	1.80	1.50	21	6	15	240	9.0	270	16.2	40.0	43.5
PU-1500G	3 φ220/380	50	1.80	1.50	21	6	15	240	9.0	270	16.2	40.0	43.5

### Outline Drawing

PU-251E

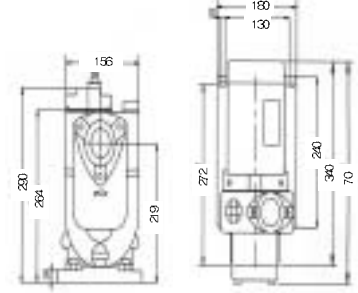

PU-400E

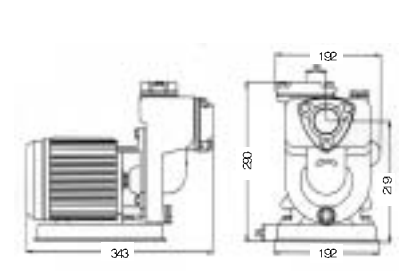

PU-461E/462E

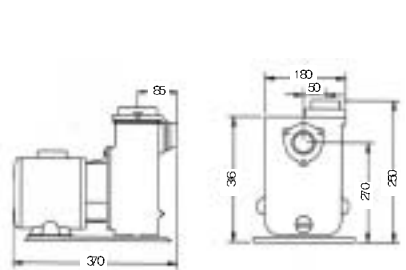

PU-1500E/1500G

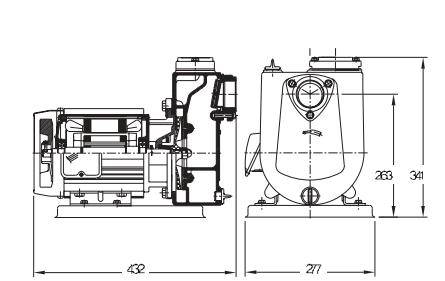

### Performance Curve

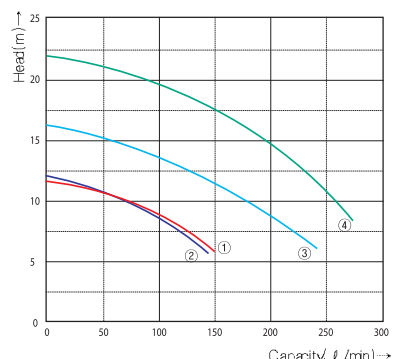

- ① PU-251E      ② PU-400E
- ③ PU-461,462E      ④ PU-1500E,1500G

# MULTI-PURPOSE



FOR VARIOUS MACHINERY



## Peripheral Pump PWN-240E

**Feature:**  
Rust Proof  
Long life  
low flow at high head

**Application:**  
Automatic vending machine, equipments for semi-conductors, etc



## Centrifugal Pump PUN series

**Feature:**  
Large flow at low head  
Compact design suitable for various application

**Application:**  
General Water supply for house, garden, various machineries

### Specification

Model	Power Source		Power (kW)		Head (m)			Rated Flow rate		Max. Flow rate		Weight (kg)	
	Voltage(V)	Frequency(Hz)	Input(p1)	Output(p2)	Total Head	Suction Head	Discharge Head	ℓ/min	At Ht	ℓ/min	m <sup>3</sup> /hr	Net	Gross
PWN-240E	220	50	0.35	0.24	24	0	24	23	0.0	23	1.4	8.0	9.0
PUN-250E	220	50	0.35	0.25	15	0	15	80	0.5	80	4.8	7.5	8.0
PUN-600E	220	50	0.95	0.60	25	0	25	115	0.5	115	6.9	12.8	13.3

### Performance Curve

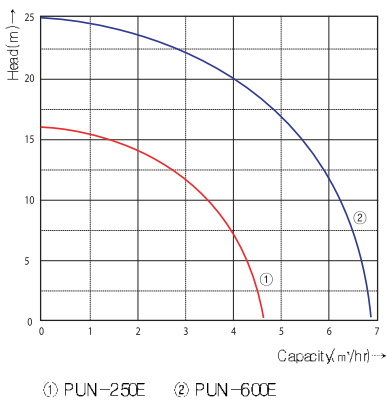
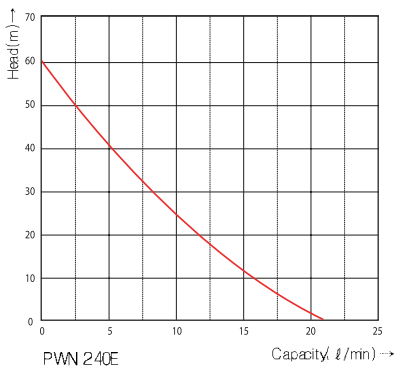

### Outline Drawing

PWN-240E

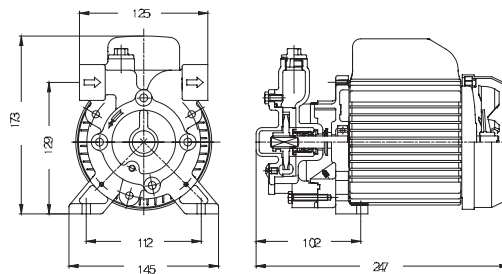

PUN-250E

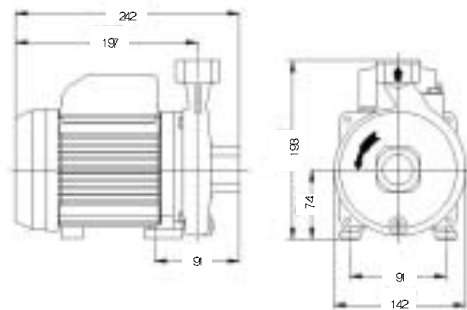

PUN-600E

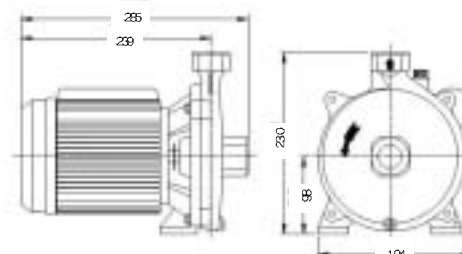



# MULTI-PURPOSE



FOR PORTABLE USE / FOR FILTERING



PF-064E

## Portable Pump for various applications PF-064E

**Feature:**  
Light and Handy

**Application:**  
Car wash, Laundry, Portable, Application

### Specification

Model	Power Source		Power (kW)		Head (m)			Rated Flow rate		Max. Flow rate		Weight (kg)	
	Voltage(V)	Frequency(Hz)	Input(p1)	Output(p2)	Total Head	Suction Head	Discharge Head	ℓ/min	At Ht	ℓ/min	m <sup>3</sup> /hr	Net	Gross
PF-064E	220	50	0.10	0.60	4	1	3	26	0.5	26	1.6	4.5	5.0

### Performance Curve

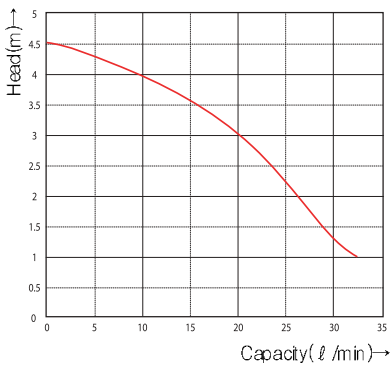

PF-064E

### Outline Drawing

PF-064E

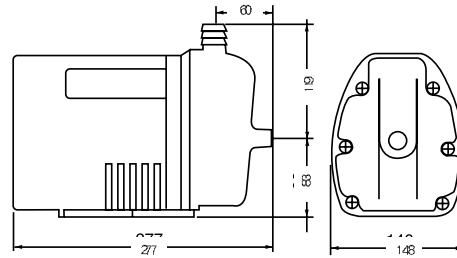

PUF-750E

## Swimming pool Filter Pump PUF-750E/1500E/1500G

**Feature:**  
Rust proof (Material of Construction: bronze)  
Easy Maintenance & Service  
Bearings of long-life  
Liquid Temp: up to 60 °C

**Application:**  
Public Bath, Swimming Pool, Sauna, Sand Filtering, General Pressure Boosting

### Specification

Model	Power Source		Power (kW)		Head (m)			Rated Flow rate		Max. Flow rate		Weight (kg)	
	Voltage(V)	Frequency(Hz)	Input(p1)	Output(p2)	Total Head	Suction Head	Discharge Head	ℓ/min	At Ht	ℓ/min	m <sup>3</sup> /hr	Net	Gross
PUF-750E	220	50	0.97	0.75	12	0	12	220	0.5	220	13.2	27.0	28.0
PUF-1500E	220	50	1.44	1.20	17	0	17	280	0.5	280	16.8	42.5	43.5
PUF-1500G	3-ø220/380	50	1.44	1.20	17	0	17	280	0.5	280	16.8	42.5	43.5

### Performance Curve

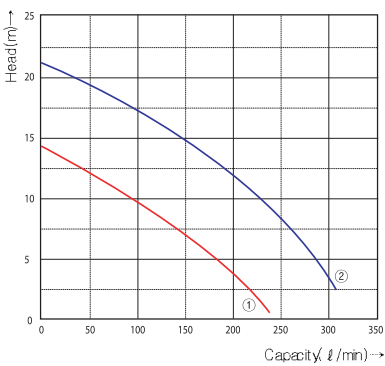

① PUF-750E    ② PUF-1500E, 1500G

### Outline Drawing

PUF Series

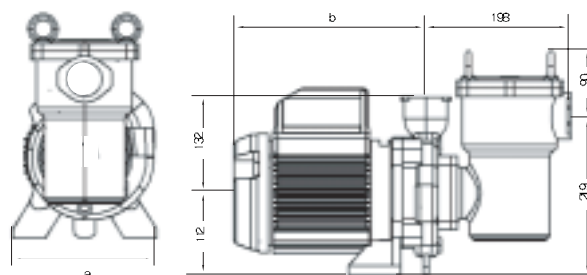

Model	a	b
PUF-750E	195	262
PUF-1500E/G	235	304



### Centrifugal Pump for whirlpool bath application WP-553E

- Feature:**  
 Air Switch for safety  
 Low noise  
 Liquid Temp: up to 60 °C  
 IP55

**Application:**  
 Whirlpool Bath, Spa

#### Specification

Model	Power Source		Power (kW)		Head (m)			Rated Flow rate		Max. Flow rate		Weight (kg)	
	Voltage(V)	Frequency(Hz)	Input(p1)	Output(p2)	Total Head	Suction Head	Discharge Head	ℓ/min	At Ht	ℓ/min	m <sup>3</sup> /hr	Net	Gross
WP-403E	230	50	0.56	0.4	7	0	7	150	7.0	250	16.0	7.0	8.0

#### Performance Curve

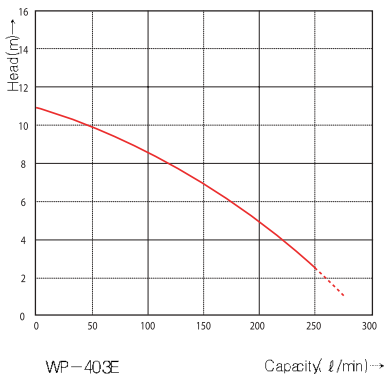

#### Outline Drawing

WP-403E

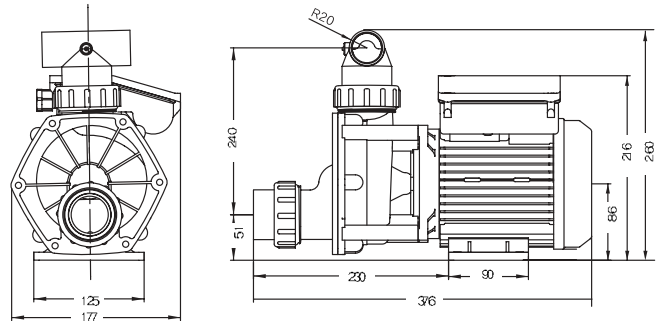



# Sea Water Application

Sea Water Application in Surface Application  
Sea Water Application in Submersible Application



*Pumpen Intelligenz.*



# SEA WATER APPLICATION



## SURFACE



### For Surface PU-S400E/S750E/S750G



#### Feature:

- Light
- Portable by lifting handle (PU-S400E Only)
- Durable against seawater
- Casing: Engineering Plastic
- Impeller: Bronze for 400 series and Stainless Steel for 750 series

#### Application:

Various sea water application (aquarium, rusty application), Agricultural Application  
Weak acidic or alkaline application for 750 Series (Please contact us for confirmation)



#### Specification

Model	Power Source		Power (kW)		Head (m)			Rated Flow rate		Max. Flow rate		Weight (kg)	
	Voltage(V)	Frequency(Hz)	Input(p1)	Output(p2)	Total Head	Suction Head	Discharge Head	ℓ/min	At Ht	ℓ/min	m <sup>3</sup> /hr	Net	Gross
PU-S400E	220	50	0.66	0.40	9	6	3	110	7.0	160	9.6	10.5	11.0
PU-S750E	220	50	1.00	0.75	15	6	9	200	9.0	300	18.0	23.0	24.0
PU-S750G	3 (3220/380)	50	1.00	0.75	15	6	9	200	9.0	300	18.0	23.0	24.0

### Performance Curve

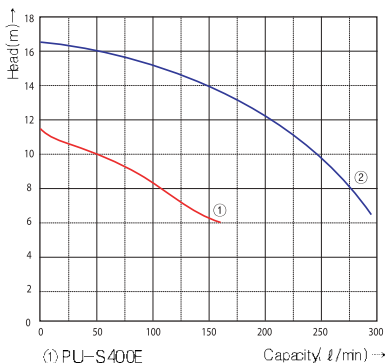

① PU-S400E  
② PU-S750E, PU-S750G

### Outline Drawing

PU-S400E

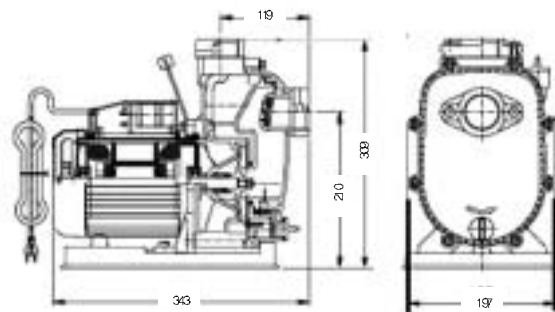

PU-S750E

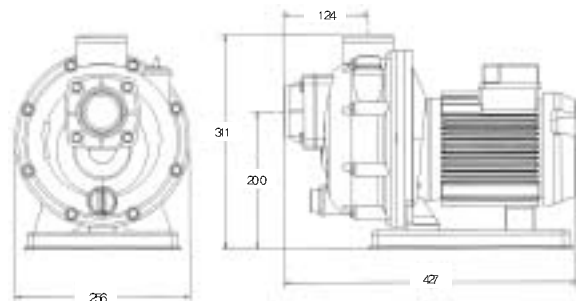

## SUBMERSIBLE



PD-S401E/EA

### For Submersible PD-S401EA/PD-S751EA/S401E/S751E

**Feature:**  
 Corrosion-Resistant by Aluminum Galvanic Anode  
 Leak-proof design-Double Mechanical Seal/Epoxy molding cable assembly  
 Automatic Operation by Float Switches (PD-S401EA, PD-S751EA only)

**Application:**  
 Sea Water Drainage Application (aquarium, fish farm, etc)

### Specification

Model	Power Source		Power (kW)		Head (m)			Rated Flow rate		Max. Flow rate		Weight (kg)	
	Voltage(V)	Frequency(Hz)	Input(p1)	Output(p2)	Total Head	Suction Head	Discharge Head	l/min	At Ht	l/min	m <sup>3</sup> /hr	Net	Gross
PD-S401E	220	50	0.51	0.35	10		10	150	5.0	225	13.5	11.5	12.5
PD-S751E	220	50	0.95	0.70	14		14	220	7.0	183	11.0	14.5	15.5
PD-S401EA	220	50	0.50	0.40	10		10	150	5.0	225	13.5	12.5	13.5
PD-S750EA	220	50	0.95	0.70	14		14	220	7.0	183	11.0	15.5	16.5

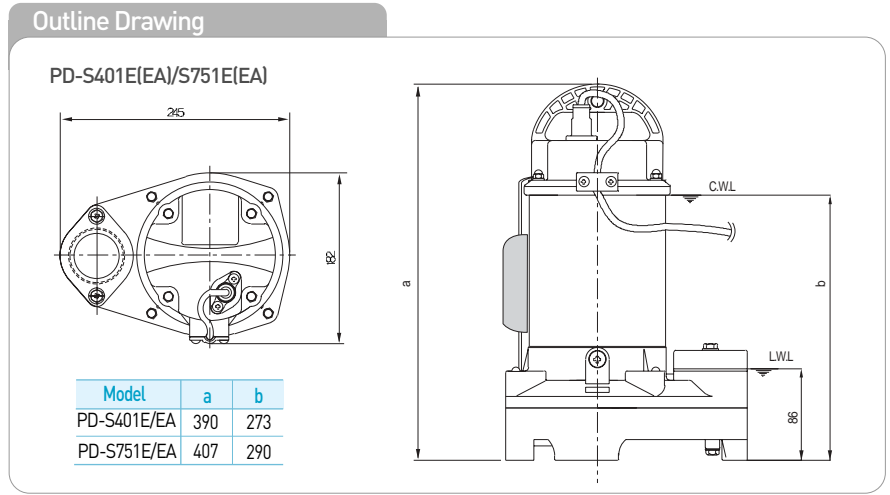
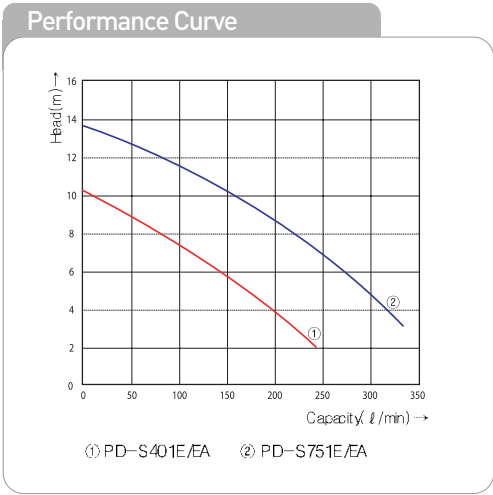



*Pumpen Intelligenz.*





# Hot Water Circulation

## Hot Water Circulation

- Boiler Application
- General heating application







## Glanded DRY Runner Pump PH Series

**Feature:**  
 Light and excellent in design  
 In-line  
 Liquid Temp: up to 80 °C

**Application:**  
 Hot water circulation and heating system

### Specification

Model	Power Source		Power (kW)		Head (m)			Rated Flow rate		Max. Flow rate		Weight (kg)	
	Voltage(V)	Frequency(Hz)	Input(p1)	Output(p2)	Total Head	Suction Head	Discharge Head	l/min	At Ht	l/min	m <sup>3</sup> /yr	Net	Gross
PH-022E	220	50	0.05	0.02	2	0	2	25	1.0	37	2.2	4.5	5.0
PH-045E	220	50	0.09	0.04	4	0	4	28	2.5	48	2.9	4.5	5.0
PH-046E	220	50	0.09	0.04	4	0	4	28	2.5	48	2.9	4.5	5.0
PH-101E	220	50	0.02	0.10	5	0	5	85	3.0	140	8.4	9.5	10.0
PH-123E	220	50	0.26	0.12	5	0	5	150	3.0	170	10.2	13.0	13.5
PH-251E	220	50	0.52	0.25	8	0	8	210	4.0	300	18.0	20.5	21.0
PH-252E	220	50	0.52	0.25	8	0	8	210	4.0	300	18.0	20.5	21.0
PH-253E	220	50	0.52	0.25	8	0	8	210	4.0	300	18.0	20.5	21.0
PH-254E	220	50	0.33	0.25	15	0	15	50	10.0	110	6.6	13.0	13.0
PH-400E	220	50	0.80	0.40	16	0	16	180	10.0	317	19.0	26.0	27.0
PH-401E	220	50	0.90	0.40	19	0	19	110	16.0	272	16.3	26.0	27.0
PH-401Q	3 ∅380	50	0.90	0.40	19	0	19	110	16.0	250	15.0	26.0	27.0
PH-1500Q	3 ∅380	50	1.80	1.50	25	0	25	200	20.0	417	25.0	38.0	40.0
PH-2200Q	3 ∅380	50	2.90	2.20	30	0	30	250	25.0	500	30.0	38.0	40.0

### Outline Drawing

PH-022E

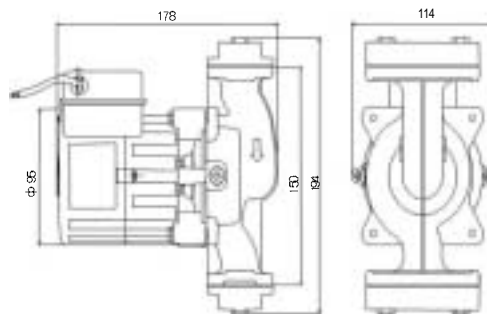

PH-045E

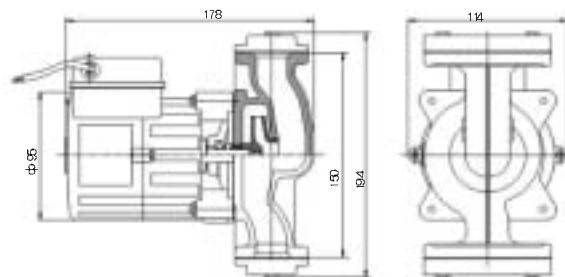



## Performance Curve

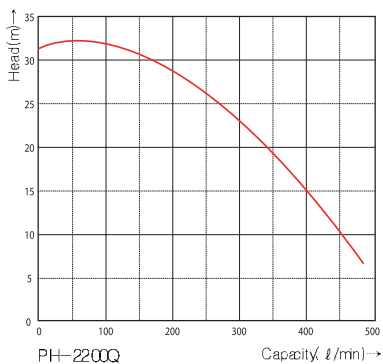
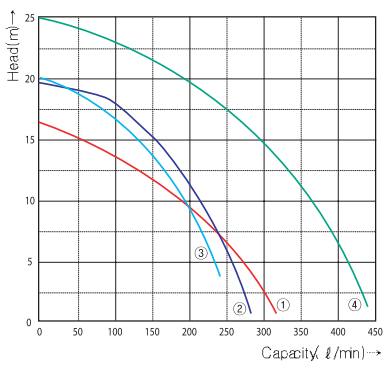
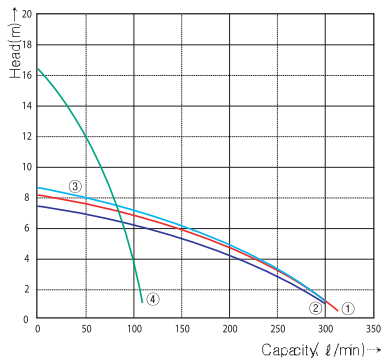
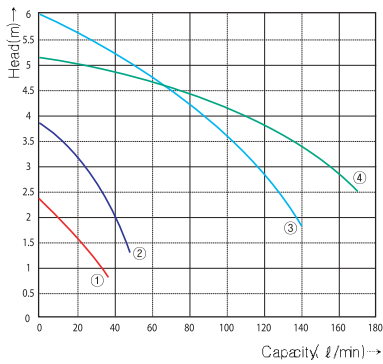

## Outline Drawing

PH-046E

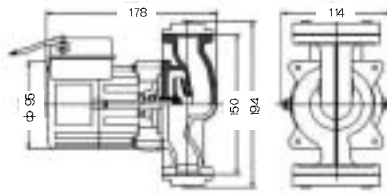

PH-101E

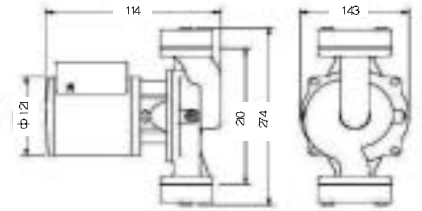

PH-101E

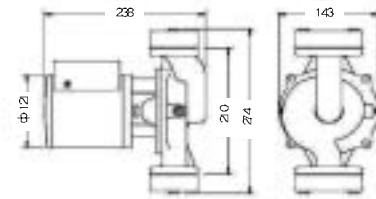

PH-123E

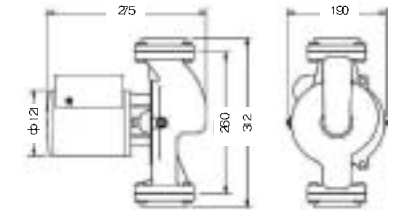

PH-251E

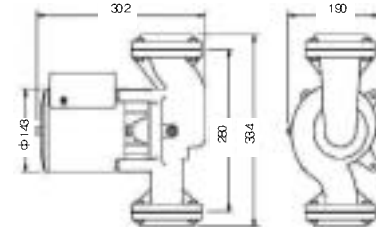

PH-252E

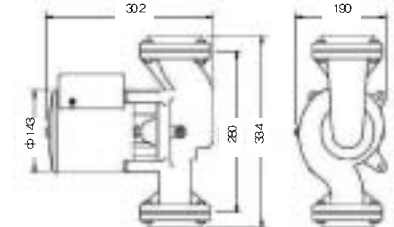

PH-253E

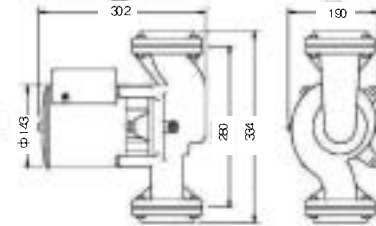

PH-254E

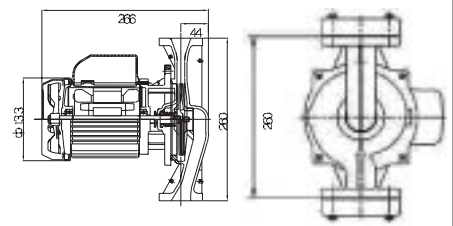

PH-400E

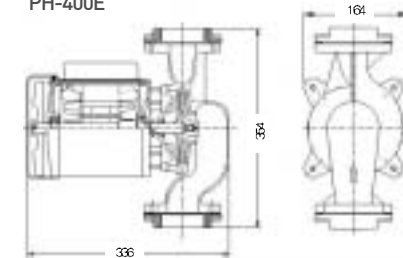

PH-401E/Q

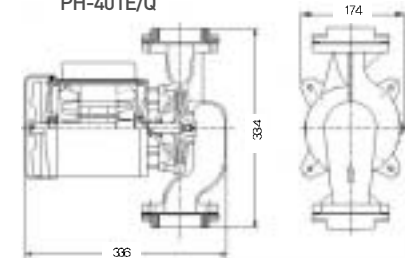

PH-1500Q

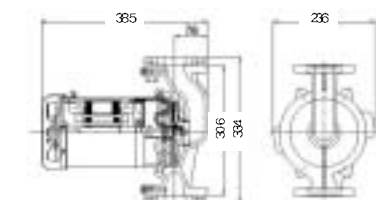

PH-2200Q

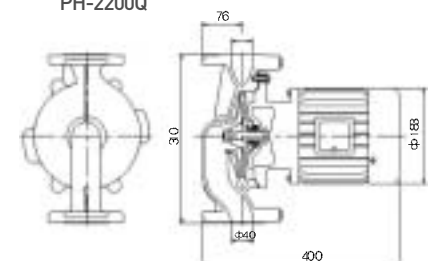



*Pumpen Intelligenz.*





# Drainage / Sewage

## Drainage & Sewage

- Compact design
- Various material of construction
- Reliable Float Switches for Automatic Operation







PD-G050E(EA)/G100(EA)



PD-125E(EA)/272E(EA)



PD-751E(EA)



PD-A401E(EA)/A751E(EA)/751Q

### Clean Water Drainage

PD-G series

#### Feature:

Automatic operation by Float switch (EA series only)  
Rust-Proof  
Light  
Portable using lifting handle  
Top Discharge (Saving Installation Space)  
Easily removable strainer for cleaning dirt, particles.  
Dewatering very low water level

#### Application:

all clean water drainage application

### Clean Water Drainage

PD-125E(EA), PD-272E(EA),

#### Feature:

Oil Seal will protect shaft from leakage  
Body & Impeller: Engineering Plastic  
Shaft: STS316  
Light  
Portable using lifting handle  
Automatic operation by float switch (EA series only)

#### Application:

Fountain, all clean water drainage application

### Clean Water Drainage

PD-751E(EA)

#### Feature:

Automatic operation by float switch (EA series only)

#### Application:

General Drainage application

### Clean Water Drainage

PD-A401E(EA)/Q, PD-A751E(EA)/Q

#### Feature:

Rust Proof Hydraulic Material  
Portable using lifting handle  
Automatic operation by float switch (EA series only)

#### Application:

Fountain, all clean water drainage application

### Specification

Model	Power Source		Power (kW)		Head (m)			Rated Flow rate		Max. Flow rate		Weight (kg)	
	Voltage(V)	Frequency(Hz)	Input(p1)	Output(p2)	Total Head	Suction Head	Discharge Head	l/min	At Ht	l/min	m <sup>3</sup> /hr	Net	Gross
PD-G050E	220	50	0.12	0.05	3.5		3.5	35	3.0	45	2.7	4.3	5.1
PD-G050EA	220	50	0.12	0.05	3.5		3.5	35	2.0	45	2.7	5.0	6.0
PD-G100E	220	50	0.19	0.10	5.0		5.0	45	3.0	75	4.5	5.5	6.3
PD-G100EA	220	50	0.19	0.10	5.0		5.0	45	3.0	75	4.5	6.0	7.0
PD-125E	220	50	0.18	0.12	5.0		5.0	45	3.0	100	6.0	5.5	6.0
PD-125EA	220	50	0.18	0.12	5.0		5.0	45	3.0	100	6.0	4.5	5.0
PD-272E	220	50	0.38	0.25	6.5		6.5	110	3.0	160	9.6	6.0	6.5
PD-272EA	220	50	0.38	0.25	6.5		6.5	110	3.0	160	9.6	6.0	6.5
PD-751E	220	50	0.90	0.75	10.0		10.0	195	7.0	300	18.0	24	25
PD-751EA	220	50	1.00	0.75	10.0		10.0	195	7.0	300	18.0	24	25
PD-A401E	220	50	0.50	0.40	10.0		10.0	30	5.0	225	13.5	12	13
PD-A401EA	220	50	0.50	0.40	10.0		10.0	150	5.0	225	13.5	11	12
PD-A401H	3Φ, 220	50	0.55	0.40	10.0		10.0	30	5.0	225	13.5	12	13
PD-A401Q	3Φ, 400	50	0.55	0.40	10.0		10.0	30	5.0	225	13.5	12	13
PD-A751E	220	50	1.00	0.75	14.0		14.0	12	20.0	300	18.0	14	15
PD-A751H	3Φ, 220	50	1.00	0.75	14.0		14.0	12	20.0	300	18.0	14	15
PD-A751Q	3Φ, 400	50	1.00	0.75	14.0		14.0	12	20.0	300	18.0	14	15

### Performance Curve

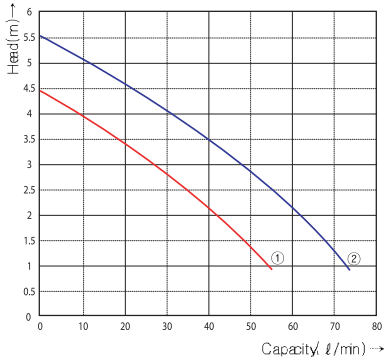

① PD-G050E(A)    ② PD-G100E(A)

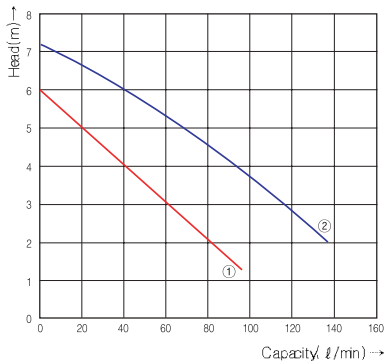

① PD-125E(A)/272E(A)    ② PD-272EA

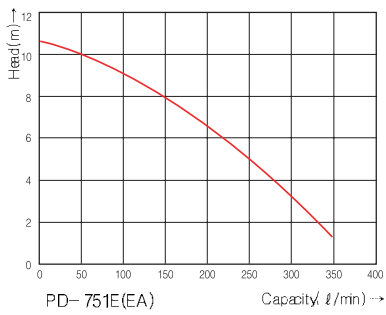

PD-751E(A)

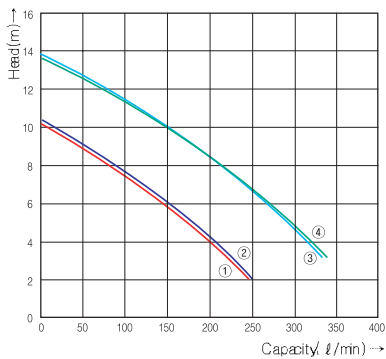

① PD-A401E(A)    ② PD-A401Q  
③ PD-A751E(A)    ④ PD-A751Q

### Outline Drawing

#### PD-G Series

Model	a	b	c
PD-G050EA	34.5	200	20,25(Hose)
PD-G100EA	34.5	220	1"pipe

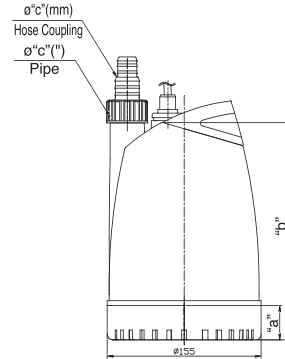

#### PD-125E(EA)/272E(EA)

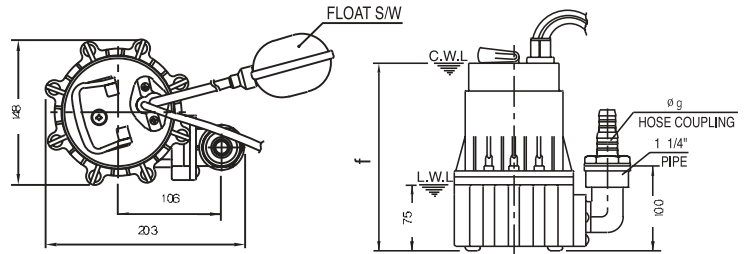

Model	f	Ø g (mm,inch)
PD-125E/EA	230	20,25,1 1/4"
PD-272E/EA	270	25,32,1 1/4"

#### PD-751E(EA)

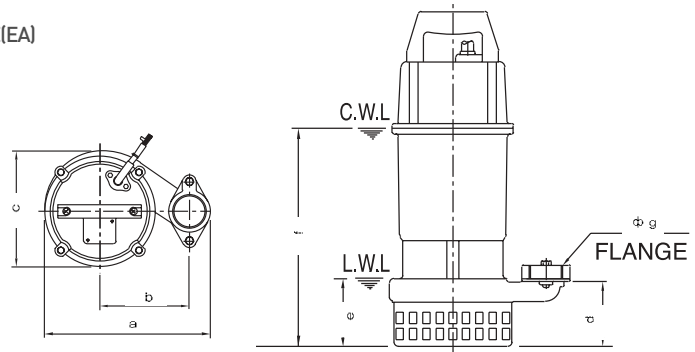

Model	a	b	c	d	e	f	Ø g
PD-751E/EA	248	130	171	93	102	298	50

#### PD-A401E(EA)/A751E(EA)/A751Q

Model	a	b	c
PD-A401E/H/Q	390	273	86
PD-A751E/H/Q	407	290	86
PD-A400EA	411	293	106
PD-A750E	428	310	106

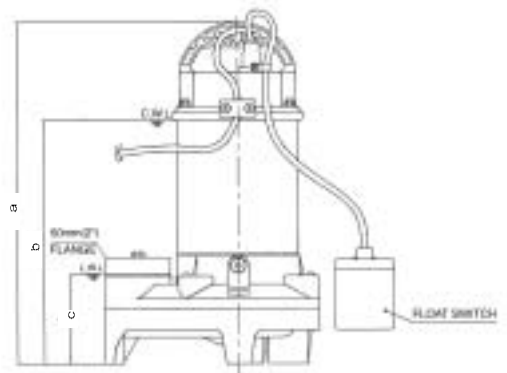
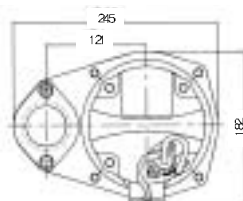



PD-S300E(EA)/S550E(EA)

### Clean Water Drainage PD-S Series

**Feature:**

- Stainless Steel Material
- Vertical Discharge - Save up installation space
- Automatic Operation by float switches (For EA MODEL only)
- CE certificate

**Application:**

clean water drainage

**Specification**

Model	Power Source		Power (kW)		Head (m)			Rated Flow rate		Max. Flow rate		Weight (kg)	
	Voltage(V)	Frequency(Hz)	Input(p1)	Output(p2)	Total Head	Suction Head	Discharge Head	l/min	At Ht	l/min	m <sup>3</sup> / hr	Net	Gross
PD-S300E	220	50	0.55	0.30	8.5		8.5	80	5.0	183	11.0	6.2	6.7
PD-S550E	220	50	0.90	0.60	11.6		11.6	130	5.0	217	13.0	7.3	8.2
PD-S300EA	220	50	0.55	0.30	8.6		8.6	80	5.0	183	11.0	6.7	7.1
PD-S550EA	220	50	0.90	0.60	11.6		11.6	130	5.0	217	13.0	7.8	8.7

### Performance Curve

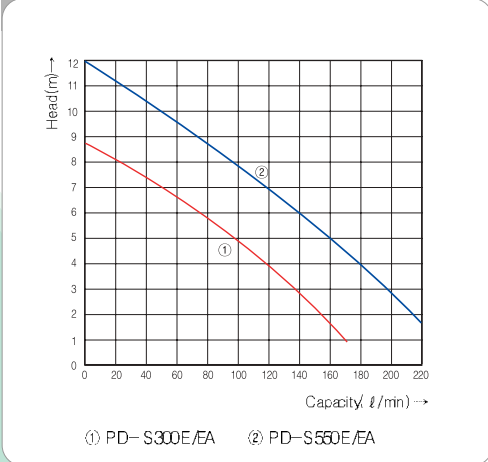

### Outline Drawing

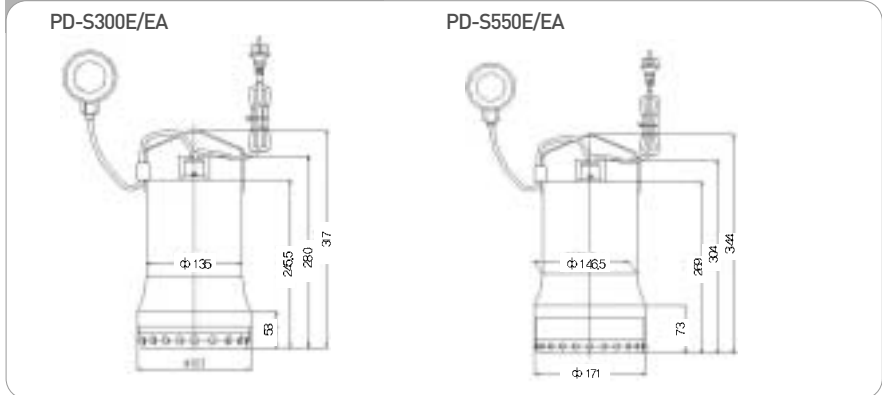



PDV-S600E(EA)/S750E(EA)

### Vortex PDV-S Series

**Feature:**

- Cast Iron Pump housing (Rust proof Material for rest of hydraulic components)
- Vertical Discharge - Save up installation space
- Thermal Motor Protection (restarts after motor cools)
- Vortex Impellers
- Free Passage: 40mm
- Automatic Operation by float switches (For EA MODEL only)
- CE certificate

**Application:**

wastewater, clean water drainage



PDV-A400E(EA)/750E(EA)

### Vortex PDV-A series

**Feature:**

- Vortex Impeller
- Automatic operation by Float switch (EA series only)
- Rust Proof Material

**Application:**

Sewage Application

**Specification**

Model	Power Source		Power (kW)		Head (m)			Rated Flow rate		Max. Flow rate		Weight (kg)	
	Voltage(V)	Frequency(Hz)	Input(p1)	Output(p2)	Total Head	Suction Head	Discharge Head	l/min	At Ht	l/min	m <sup>3</sup> /hr	Net	Gross
PDV-A400EA	220	50	0.50	0.40	7.0		7.0	150	4.0	233	14.0	12.5	13.5
PDV-S400EA	220	50	0.50	0.40	7.0		7.0	150	4.0	233	14.0	13.5	14.5
PDV-S600EA	220	50	0.83	0.60	8.0		8.0	240	2.0	283	17.0	20	21
PDV-750EA	220	50	1.00	0.75	8.0		8.0	150	6.0	310	18.6	24.5	25.5
PDV-S750EA	220	50	1.00	0.75	10.0		10.0	270	3.0	317	19.0	20	21
PDV-A400E	220	50	0.50	0.40	7.0		7.0	150	4.0	233	14.0	12	13
PDV-S400E	220	50	0.50	0.40	7.0		7.0	150	4.0	233	14.0	13	14
PDV-S600E	220	50	0.83	0.60	8.0		8.0	240	2.0	283	17.0	20	21
PDV-S600Q	3∅, 400	50	0.78	0.60	8.0		8.0	240	2.0	283	17.0	20	21
PDV-750E	220	50	1.00	0.75	8.0		8.0	150	6.0	310	18.6	24.0	25.0
PDV-A750E	220	50	1.00	0.75	10.0		10.0	220	6.0	310	18.6	20	21
PDV-S750E	220	50	1.00	0.75	10.0		10.0	270	3.0	317	19.0	20	21
PDV-S750Q	3∅, 400	50	0.92	0.75	10.0		10.0	270	3.0	317	19.0	20	21



PDV-750E(EA)





### Performance Curve

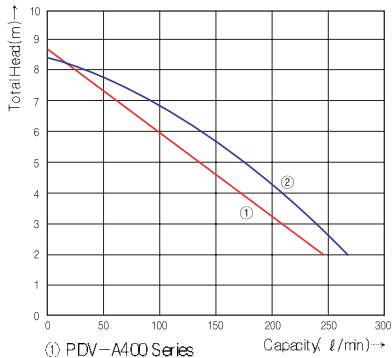

- ① PDV-S400 Series
- ② PDV-S600 Series

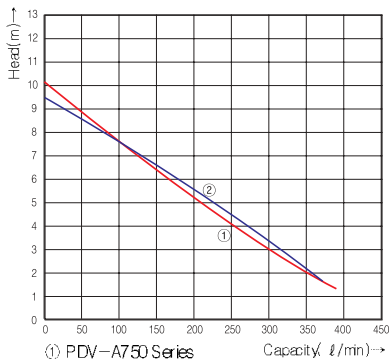

- ① PDV-S750 Series
- ② PDV-A750 Series

### Outline Drawing

PDV-S600E(EA)/S750E(EA)

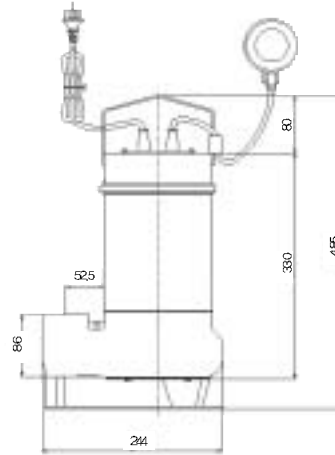

PDV-750E(EA)

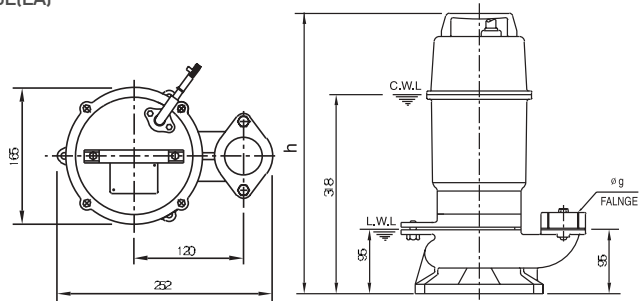

PDV-A400E(EA)/A750E(EA)

Model	a	b	c
PDV-A400Series	411	293	106
PDV-A750Series	428	310	106

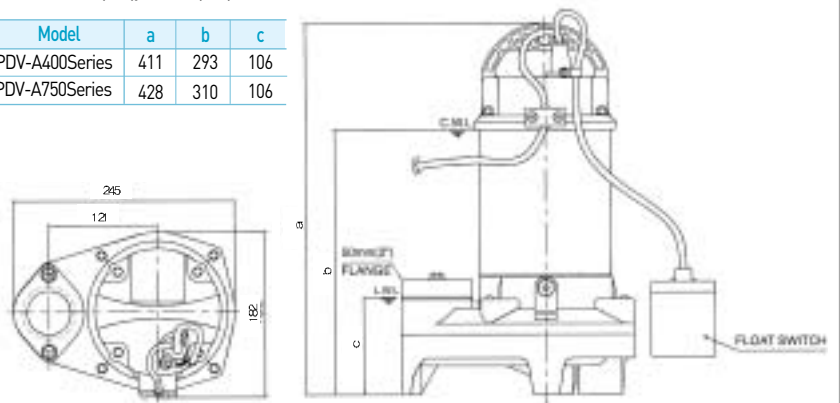



# Deep Well Application

---

# Borehole Application

Deep Well Application in Surface Application  
Deep Well Application in Submersible Borehole  
Application



*Pumpen Intelligenz.*



PC-201SEA/200SEA

PC-251EA/250EA

PC-371EA/370E

PC-401EA/400E

PC-600E

### Deep Well Pump with Jet

PC Series

**Feature:**  
 Easy installation  
 Automatic operation (EA series only)  
 Self-Priming  
 Max Suction Lift: 24m (limited models only)

**Application:**  
 Water supply from deep well,

#### Specification

Model	Power Source		Power (kW)		Head (m)			Rated Flow rate		JET	Weight (kg)	
	Voltage(V)	Frequency(Hz)	Input(p1)	Output(p2)	Total Head	Suction Head	Discharge Head	l/min	At Ht		Net	Gross
PC-150EA	220	50	0.30	0.15	22	15	7	9	22.0	double	30.0	34.0
PC-200SEA	220	50	0.35	0.20	22	15	7	9	22.0	double	23.0	24.0
PC-201SEA	220	50	0.35	0.20	20	13	7	10	20.0	single	23.0	24.0
PC-250EA	220	50	0.62	0.25	36	24	12	12	36.0	double	32.0	35.0
PC-251EA	220	50	0.62	0.25	30	18	12	12	30.0	single	32.0	35.0
PC-370E	220	50	0.62	0.37	36	24	12	12	36.0	double	16.5	17.5
PC-371E	220	50	0.62	0.37	30	18	12	12	30.0	single	13.0	13.5
PC-400E	220	50	0.75	0.40	35	24	11	13	35.0	double	28.0	29.0
PC-401E	220	50	0.75	0.40	34	20	14	8	34.0	single	26.0	27.0
PC-500E	220	50	1.35	1.10	54	24	30	20	54.0	double	28.0	29.0
PC-501E	220	50	1.35	1.10	48	18	30	18	48.0	single	24.0	25.0
PC-600E	220	50	0.79	0.75	21	9	12	20	21.0	built-in	15.5	16.5

#### Outline Drawing

PC-150EA

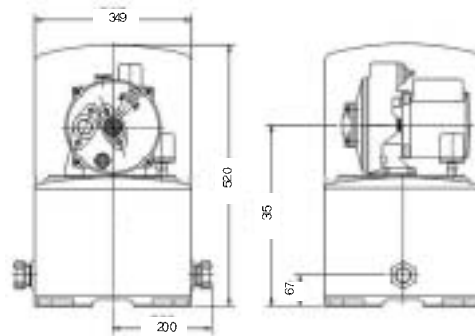

PC-250EA/251EA

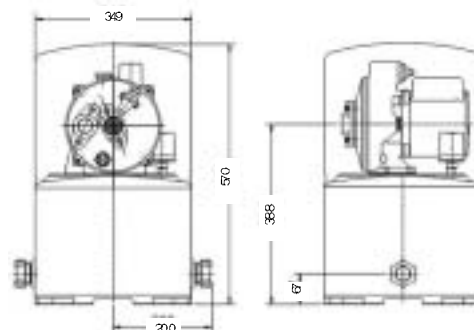



### Performance Curve

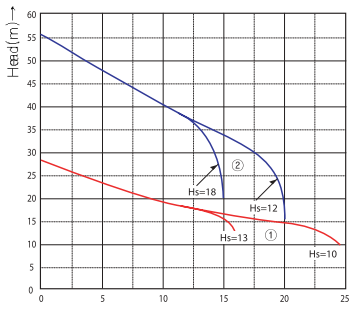

Capacity, l/min →  
① PC-201SEA ② PC-251EA

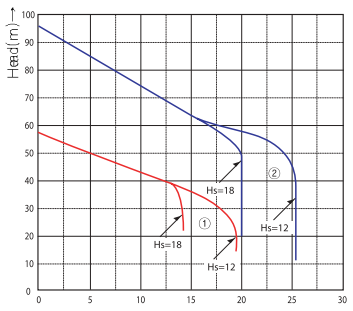

Capacity, l/min →  
① PC-371E ② PC-501E

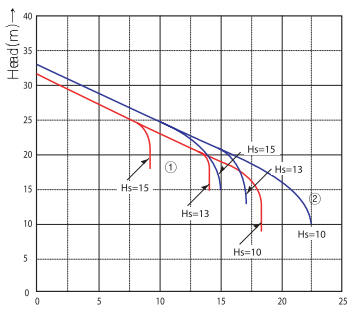

Capacity, l/min →  
① PC-150EA ② PC-200SEA

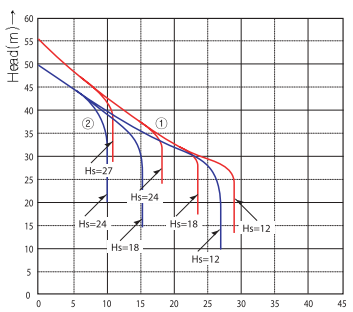

Capacity, l/min →  
① PC-250EA ② PC-370E

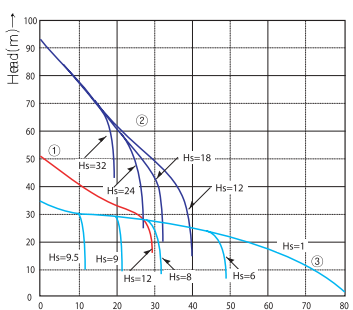

Capacity, l/min →  
① PC-400E/401E ② PC-500E ③ PC-600E

### Outline Drawing

PC-201SEA/200SEA

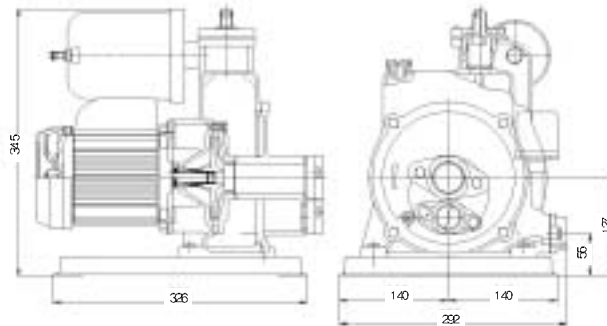

PC-370E/371E

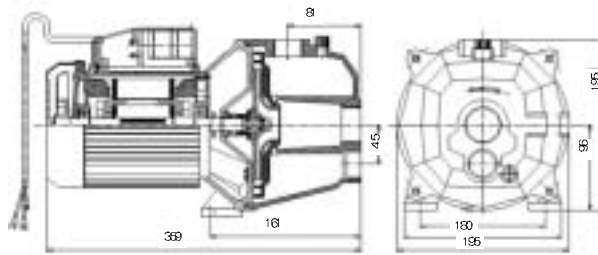

PC-400E/401E

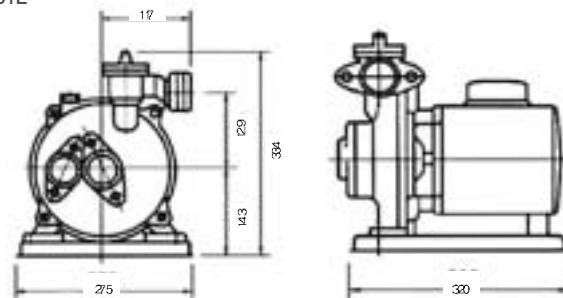

PC-500E/501E

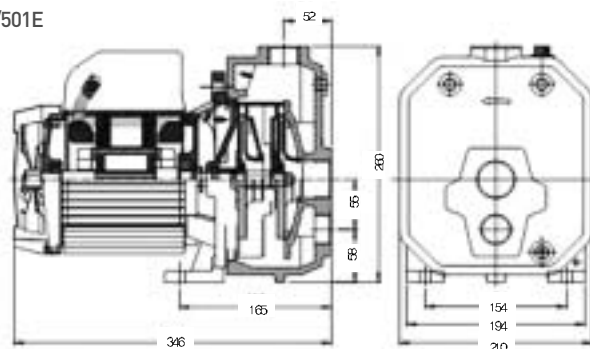





### Plastic PLS series

**Feature:**  
 GE: for high head  
 HE: for medium head  
 QE: for big flow  
 Rust-Proof Material  
 With Franklin Motor (USA)  
 Low current  
 Easy maintenance

**Application:**  
 deep well application

### Specification

Model	Power Source		Power (kW)		Head (m)			Rated Flow rate		Max. Flow rate		Weight (kg)	
	Voltage(V)	Frequency(Hz)	Input(p1)	Output(p2)	Total Head	Suction Head	Discharge Head	ℓ/min	At Ht	ℓ/min	m <sup>3</sup> /hr	Net	Gross
PLS-1012GE	220	50	1.35	0.75	90	0	90	30	55.0	40	2.4	15.9	15.9
PLS-2012GE	220	50	1.90	1.50	190	0	190	25	135.0	40	2.4	22.5	22.5
PLS-2033GE	3 $\phi$ , 380	50	1.90	1.50	190	0	190	25	135.0	40	2.4	22.5	22.5
PLS-1012HE	220	50	1.20	0.75	60	0	60	60	40.0	85	5.1	14.4	14.4
PLS-2012HE	220	50	2.10	1.50	115	0	115	60	77.0	85	5.1	20.0	20.0
PLS-2033HE	3 $\phi$ , 380	50	2.10	1.50	115	0	115	60	77.0	85	5.1	20.0	20.0
PLS-3012HE	220	50	3.00	2.20	185	0	185	65	105.0	90	5.4	32.0	32.0
PLS-3033HE	3 $\phi$ , 380	50	3.00	2.20	185	0	185	65	105.0	90	5.4	32.0	32.0
PLS-7533HE	3 $\phi$ , 380	50	8.00	5.50	155	0	155	190	110.0	250	15.0	65.0	65.0
PLS-10033HE	3 $\phi$ , 380	50	10.20	7.50	195	0	195	200	140.0	250	15.0	75.0	75.0
PLS-2012QE	220	50	2.70	1.50	45	0	45	150	30.0	210	12.6	21.9	21.9
PLS-2033QE	3 $\phi$ , 380	50	2.70	1.50	45	0	45	150	30.0	210	12.6	21.9	21.9
PLS-3012QE	220	50	3.30	2.20	65	0	65	150	48.0	200	12.0	34.0	34.0
PLS-3033QE	3 $\phi$ , 380	50	3.30	2.20	65	0	65	150	48.0	200	12.0	34.0	34.0
PLS-5033QE	3 $\phi$ , 380	50	4.90	3.70	90	0	90	150	55.0	200	12.0	40.0	40.0

### Performance Curve

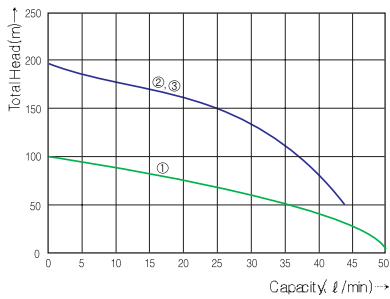

① PLS-1012GE    ② PLS-2012GE  
 ③ PLS-2033GE

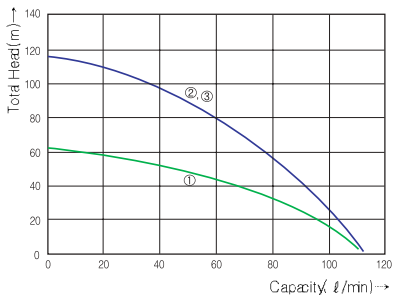

① PLS-1012HE    ② PLS-2012HE  
 ③ PLS-2033HE

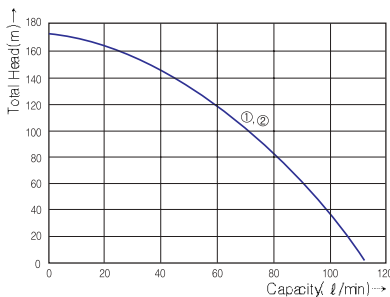

① PLS-3012HE    ② PLS-3033HE

# BOREHOLE APPLICATION



## SUBMERSIBLE



### Performance Curve

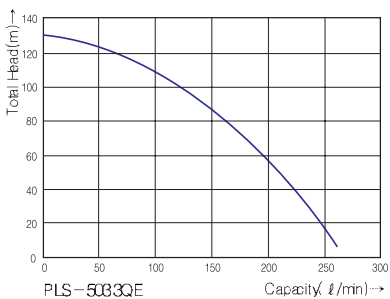
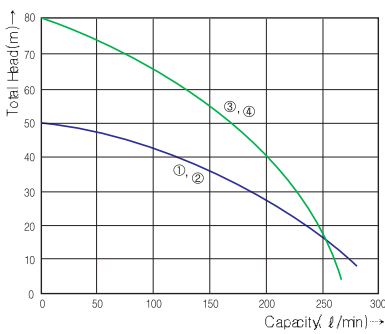
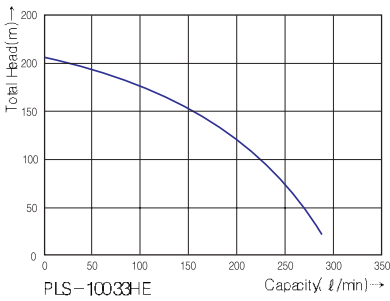
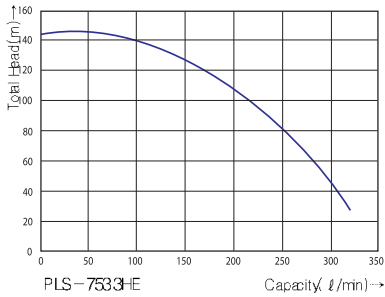

### Outline Drawing

PLS-1012GE/2012GE/2033GE

PLS-1012HE/2012HE/2033HE/  
3012HE/3033HE

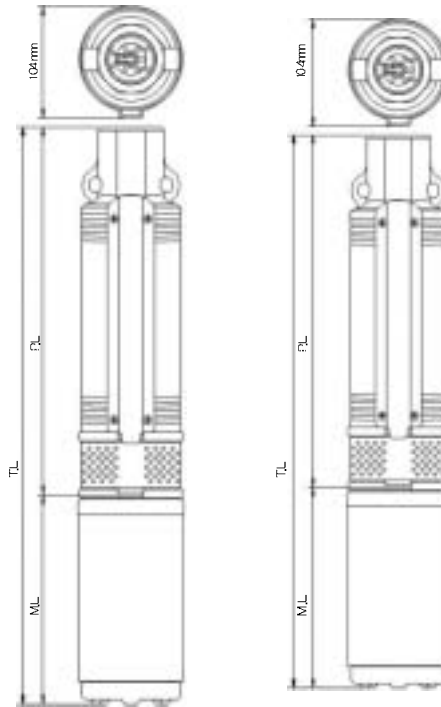

Model	P.L	M.L	T.L
PLS-1012GE	625	270	895
PLS-2012GE	1070	345	1415
PLS-2033GE	1070	345	1415
PLS-1012HE	445	270	715
PLS-2012HE	690	345	1035
PLS-2033HE	690	345	1035
PLS-3033HE	940	523	1463

PLS-2012QE/2033QE/3012QE/  
3033QE/5033QE

PLS-7533H/10033H

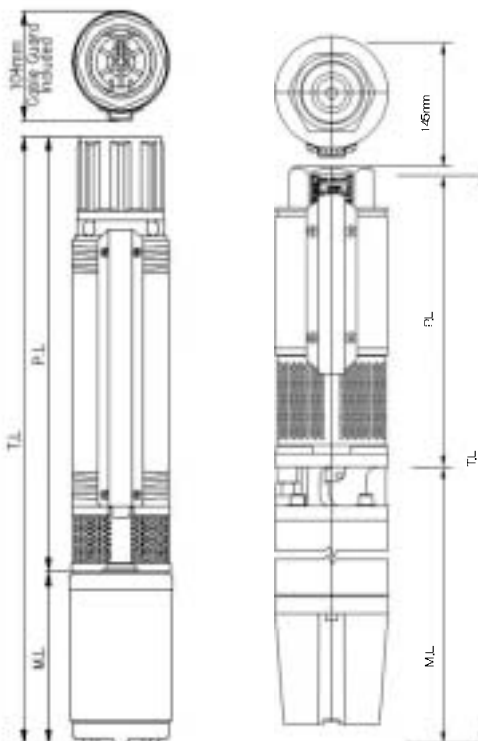

Model	P.L	M.L	T.L
PLS-2012QE	660	345	1005
PLS-2033QE	660	345	1005
PLS-3012QE	945	523	1468
PLS-3033QE	945	523	1468
PLS-5033QE	1444	602	2046
PLS-7533H	648	614	1262
PLS-10033H	747	646	1393







# Wilo Pumps Korea Products Ranges



Type	Model	Power Source		Power (kW)		Head (m)			Rated Flow rate		Max. Flow rate		Condition			Piping(mm/inch)		Size(m)			Weight (kg)			Q'ty(pcs)		
		Voltage(V)	Frequency(Hz)	Input(p1)	Output(p2)	Total Head	Suction Head	Discharge Head	ℓ/min	At Ht	ℓ/min	m <sup>3</sup> / hr	Max.Temp	Max.Press	IP Class	Inlet	Outlet	Length	Width	Height	Net	Gross	Pallets	20T±CT	40T±CT	
Sewage	Automatic	PDV-A400EA	220	50	0.50	0.40	7.0		7.0	150	4.0	233	14.0	40	1.1	IP68		50	0.280	0.220	0.520	12.5	13.5	45	450	900
		PDV-S400EA	220	50	0.50	0.40	7.0		7.0	150	4.0	233	14.0	40	1.1	IP68		50	0.280	0.220	0.520	13.5	14.5	45	450	900
		PDV-S600EA	220	50	0.83	0.60	8.0		8.0	240	2.0	283	17.0	40	1.2	IP68		40	0.270	0.210	0.520	20	21	45	450	900
		PDV-750EA	220	50	1.00	0.75	8.0		8.0	150	6.0	310	18.6	40	1.2	IP68		50	0.280	0.220	0.570	24.5	25.5	45	450	810
		PDV-S750EA	220	50	1.00	0.75	10.0		10.0	270	3.0	317	19.0	40	1.5	IP68		50	0.270	0.210	0.520	20	21	45	450	900
		PDV-A400E	220	50	0.50	0.40	7.0		7.0	150	4.0	233	14.0	40	1.1	IP68		50	0.280	0.220	0.520	12	13	45	450	900
	Manual	PDV-S400E	220	50	0.50	0.40	7.0		7.0	150	4.0	233	14.0	40	1.1	IP68		50	0.280	0.220	0.520	13	14	45	450	900
		PDV-S600E	220	50	0.83	0.60	8.0		8.0	240	2.0	283	17.0	40	1.2	IP68		40	0.270	0.210	0.520	20	21	45	450	900
		PDV-S600Q	3Φ, 400	50	0.78	0.60	8.0		8.0	240	2.0	283	17.0	40	1.2	IP68		40	0.270	0.210	0.520	20	21	45	450	900
		PDV-750E	220	50	1.00	0.75	8.0		8.0	150	6.0	310	18.6	40	1.2	IP68		50	0.280	0.220	0.570	24	25	45	450	810
		PDV-A750E	220	50	1.00	0.75	10.0		10.0	220	6.0	310	18.6	40	1.5	IP68		40	0.280	0.220	0.540	20	13	45	450	900
		PDV-S750E	220	50	1.00	0.75	10.0		10.0	270	3.0	317	19.0	40	1.5	IP68		40	0.270	0.210	0.520	20	21	45	450	900
PDV-S750Q	3Φ, 400	50	0.92	0.75	10.0		10.0	270	3.0	37	19.0	40	1.5	IP68		40	0.270	0.210	0.520	20	21	45	450	900		
Borehole Pump	High Head	PLS-1012GE	220	50	1.35	0.75	90		90	30	55.0	40	2.4	40	108.0	IP68		32	0.700	0.120	0.210	15.9	16.9		756	1,296
		PLS-2012GE	220	50	1.90	1.50	190		190	25	135.0	40	2.4	40	228.0	IP68		32	1.100	0.120	0.210	22.5	23.5		540	864
		PLS-2033GE	3Φ, 380	50	1.90	1.50	190		190	25	135.0	40	2.4	40	228.0	IP68		32	1.100	0.120	0.210	22.5	23.5		540	864
	Medium	PLS-1012HE	220	50	1.20	0.75	60		60	60	40.0	85	5.1	40	72.0	IP68		32	0.500	0.120	0.210	14.4	14.4		1,188	1,404
		PLS-2012HE	220	50	2.10	1.50	115		115	60	77.0	85	5.1	40	138.0	IP68		32	0.750	0.120	0.210	20.0	21.0		630	990
		PLS-2033HE	3Φ, 380	50	2.10	1.50	115		115	60	77.0	85	5.1	40	138.0	IP68		32	0.750	0.120	0.210	20.0	21.0		630	990
		PLS-3012HE	220	50	3.00	2.20	185		185	65	105.0	90	5.4	40	222.0	IP68		32	1.000	0.120	0.210	32.0	33.0		450	630
		PLS-3033HE	3Φ, 380	50	3.00	2.20	185		185	65	105.0	90	5.4	40	222.0	IP68		32	1.000	0.120	0.210	32.0	33.0		450	630
		PLS-7533HE	3Φ, 380	50	8.00	5.50	155		155	190	110.0	250	15.0	40	186.0	IP68		65	0.700	0.200	0.350	65.0	66.0		210	300
		PLS-10033HE	3Φ, 380	50	10.20	7.50	195		195	200	140.0	250	15.0	40	134.0	IP68		65	0.800	0.200	0.350	75.0	76.0		210	240
		PLS-2012QE	220	50	2.70	1.50	45		45	150	30.0	210	12.6	40	54.0	IP68		50	0.700	0.120	0.210	21.9	22.9		720	900
		PLS-2033QE	3Φ, 380	50	2.70	1.50	45		45	150	30.0	210	12.6	40	54.0	IP68		50	0.700	0.120	0.210	21.9	22.9		720	900
High Flow	PLS-3012QE	220	50	3.30	2.20	65		65	150	48.0	200	12.0	40	78.0	IP68		50	1.000	0.120	0.210	34.0	35.0		450	540	
	PLS-3033QE	3Φ, 380	50	3.30	2.20	65		65	150	48.0	200	12.0	40	78.0	IP68		50	1.000	0.120	0.210	34.0	35.0		450	540	
	PLS-5033QE	3Φ, 380	50	4.90	3.70	90		90	150	55.0	200	12.0	40	108.0	IP68		50	1.500	0.120	0.210	40.0	41.0		450	450	



*Pumpen Intelligenz.*



*Pumpen Intelligenz.*

## **WILO PUMPS LTD. KOREA**

### **Factory**

#5-2 Jinyeong-Ri, Jinyeong-Eup,  
Gimhae, Gyeongnam  
Korea 621-807

### **Sales**

7F Korea Investment & Securities B/D  
#446-1 Bangbae-Dong, Seocho-Gu,  
Seoul, Korea 137-060  
T: +82-2-2104-9437  
F: +82-2-3471-3330

### **Website**

[www.wilo.co.kr](http://www.wilo.co.kr)

Information in this catalogue is subject to change without prior notice